

No.	Date	Item

Project No.	Date
05002	11/18/05

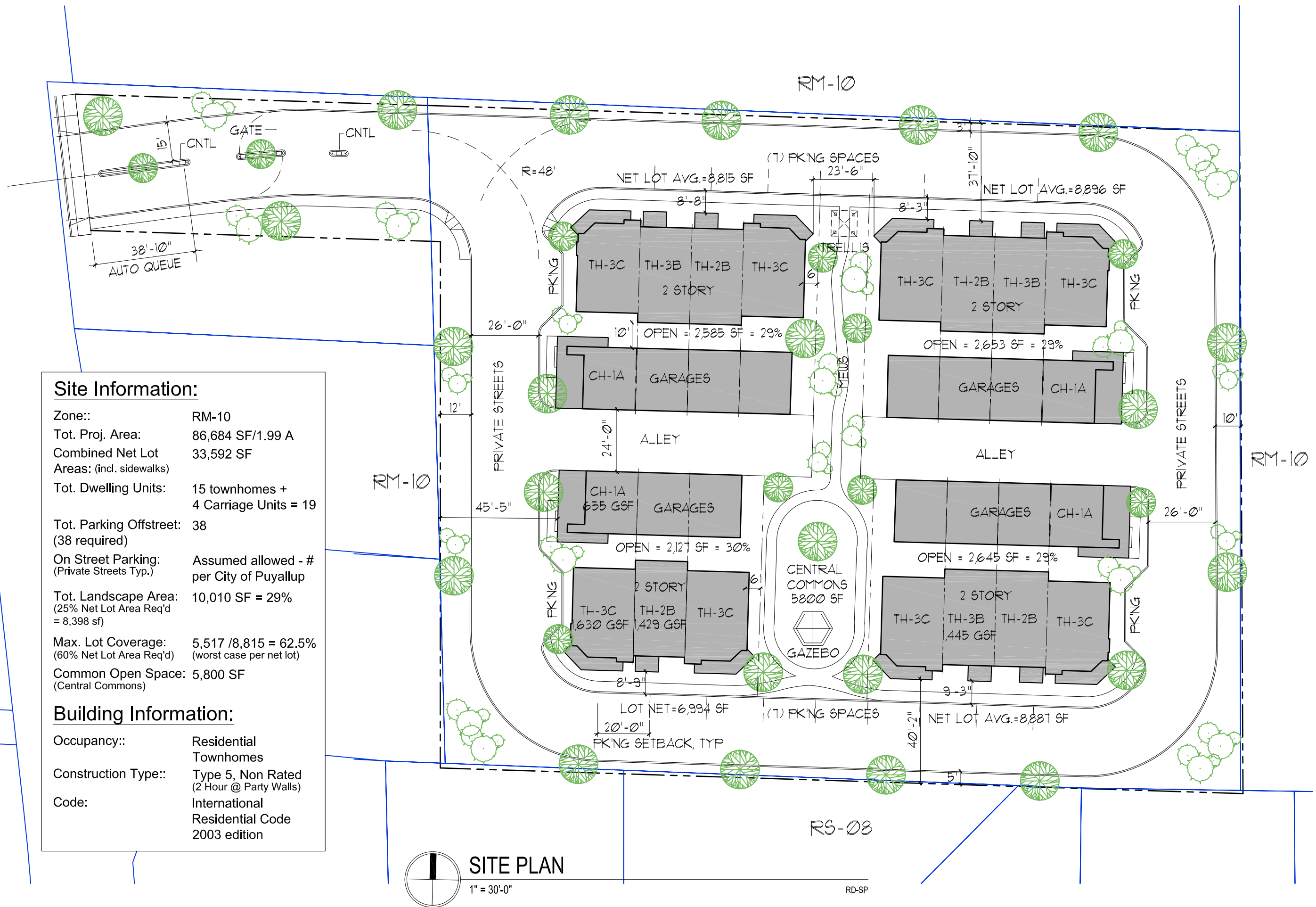

Site Information:

Zone:: RM-10
 Tot. Proj. Area: 86,684 SF/1.99 A
 Combined Net Lot Areas: (incl. sidewalks) 33,592 SF
 Tot. Dwelling Units: 15 townhomes + 4 Carriage Units = 19
 Tot. Parking Offstreet: 38 (38 required)
 On Street Parking: Assumed allowed - # per City of Puyallup (Private Streets Typ.)
 Tot. Landscape Area: 10,010 SF = 29% (25% Net Lot Area Req'd = 8,398 sf)
 Max. Lot Coverage: 5,517 / 8,815 = 62.5% (60% Net Lot Area Req'd) (worst case per net lot)
 Common Open Space: 5,800 SF (Central Commons)

Building Information:

Occupancy:: Residential Townhomes
 Construction Type:: Type 5, Non Rated (2 Hour @ Party Walls)
 Code: International Residential Code 2003 edition

SITE PLAN
1" = 30'-0"

RD-SP